

Maximum dimensions

1 module: 4.50m wide x 6m projection
 2 modules: 7m wide x 6m projection

Slat and pillar detail

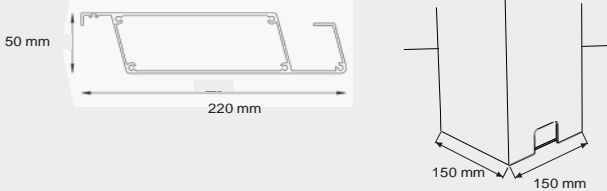

Maximum slat opening 130°

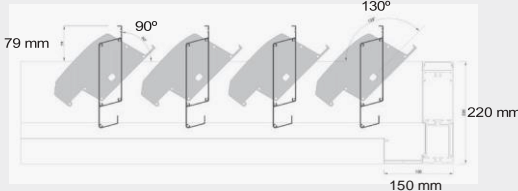

Dimensions (mm)

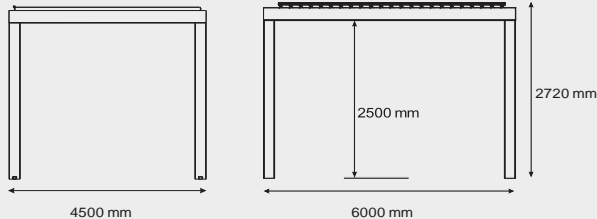

No. of Slats Line

Output	Slats	1 Module						2 Modules (*)					
		2.00	2.50	3.00	3.50	4.00	4.50	5.00	5.50	6.00	6.50	7.00	
2.00	9	✓	✓	✓	✓	✓	✓	18	✓	✓	✓	✓	✓
2.50	11	✓	✓	✓	✓	✓	✓	22	✓	✓	✓	✓	✓
3.00	14	✓	✓	✓	✓	✓	✓	28	✓	✓	✓	✓	✓
3.50	17	✓	✓	✓	✓	✓	✓	34	✓	✓	✓	✓	✓
4.00	19	✓	✓	✓	✓	✓	✓	38	✓	✓	✓	✓	✓
4.50	22	✓	✓	✓	✓	✓	✓	44	✓	✓	✓	✓	✓
5.00	25	✓	✓	✓	✓	✓	✓	50	✓	✓	✓	✓	✓
5.50	27	✓	✓	✓	✓	✓	✓	54	✓	✓	✓	✓	✓
6.00	30	✓	✓	✓	✓	✓	✓	60	✓	✓	✓	✓	✓

(*) No line-length or output limit

Profile Sections (mm)

Section dimensions in mm

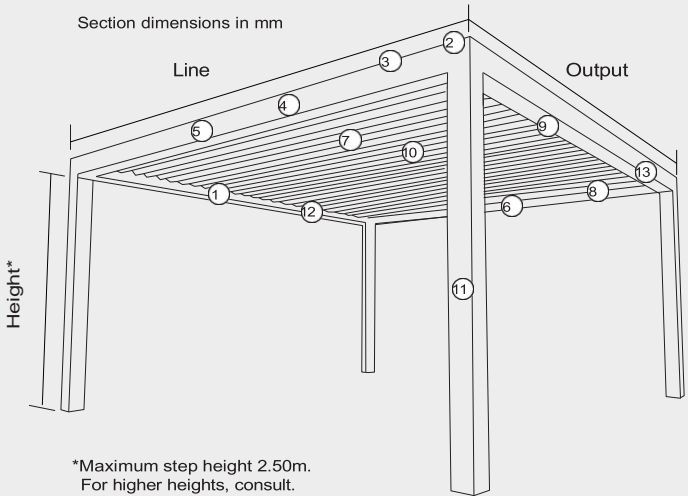

*Maximum step height 2.50m. For higher heights, consult.

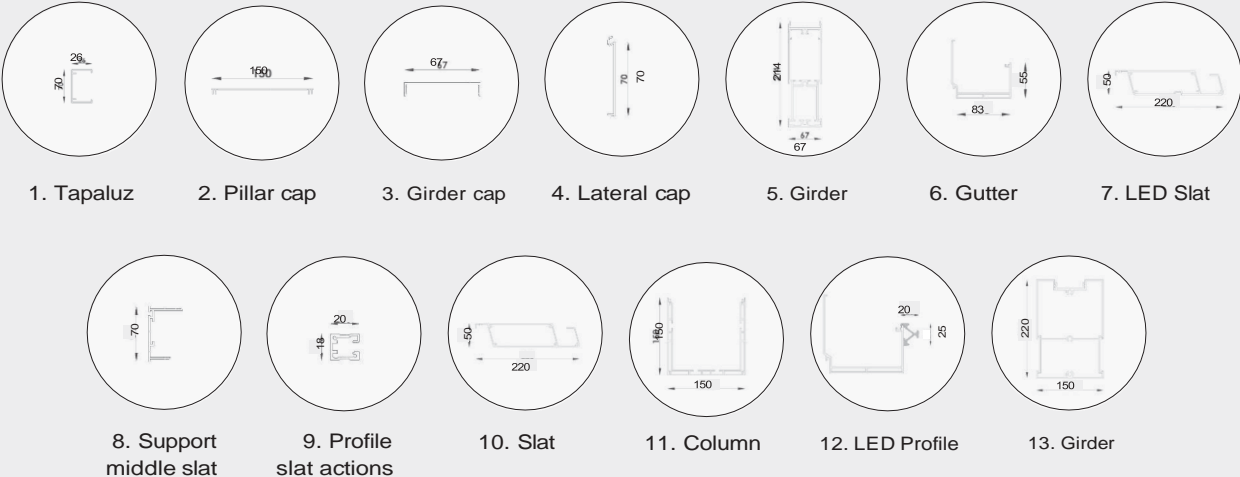



Laths and profiles



Standard blade

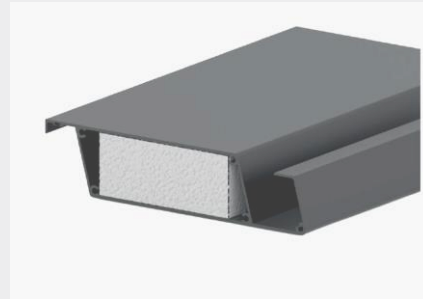

Blade with insulation



Registrable pillar



Adjustable anchorage (for unevenness)

Ducting

The interior mesh prevents splashes and muffles the sound of the water. It also prevents dirt from entering the downspouts. The water runs along the blades toward the gutter and flows to the outside through the downspout via free drainage or by slab.



Lateral enclosures

Elya is enriched with a careful selection of lateral enclosures that enhance comfort and enhance the aesthetics of the space created by this bioclimatic pergola. Solutions designed to protect, beautify and enjoy every moment, at any time of the year.

Enclosure options:

- Sliding glass curtain NUNA
- Vertical awning KLAIS
- Decorative panels



Eliza

Lighting

Lighting system available in slats and perimeter to create unique atmospheres. All options include wiring, transformer and receiver. Available in warm or neutral light.



Direct perimeter LED light



Ambient perimeter LED light



Lamps in slats

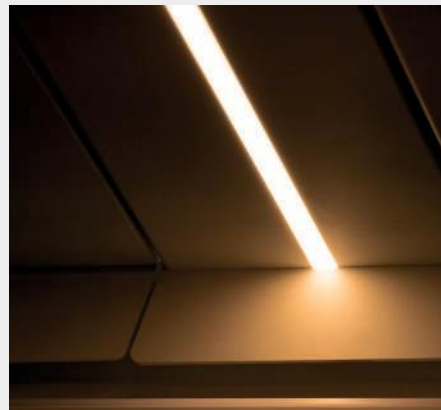

LED strip in slats

Ground anchoring

The ELYA bioclimatic pergola has 4 different types of ground anchors, and can be installed individually according to the needs of each project.



Interior base.



Exterior base.



Adjustable base. Absorbs uneven ground and provides easy-to-hide cover to conceal the mechanism.



Base tilt. Adjustable for inclination with cut-off cover to hide the mechanism, lacquered in the same color as the rest of the structure.



Hidden motorization

Hidden motorization integrated into the beam via a specific kit, fixed with accessories to ensure a safe and precise installation.

This system offers rapid and especially quiet movements, significantly reducing noise during operation. The drive can be performed either by remote control or from a smartphone, allowing control of maneuvers, lighting and other functions in a comfortable and intuitive way.

The counterweighted slats, which rotate from their central axis, optimize load distribution; only one slat is driven, which reduces the effort required by the motor and improves the efficiency and durability of the assembly.

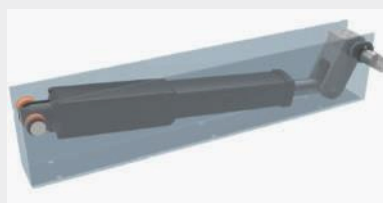

Hidden motor in beam



Driven slat

Registerable beams and pillars

Beams with a top access for passing cables and connections. The cover embraces the profile to prevent water ingress. Quick-connectors on electronic components.



Operation



Ventilation System by natural convection



Solar protection Total gradation of solar radiation



Protection against rain Roof completely rainproof

Adjustable slats



0° Fully protected from sun and rain



5° - 90° Air recirculation and temperature gradation



90° - 130° Total use of solar radiation

Modularity



Door frame wall



Perpendicular slats



2 Modules

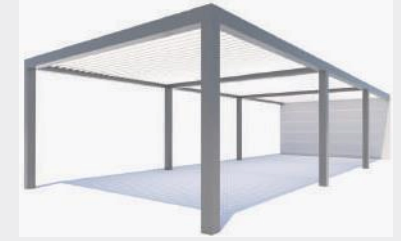

3 Modules



4 Modules



4 Modules in cross



Freestanding

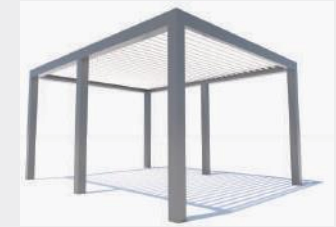

Perpendicular slats

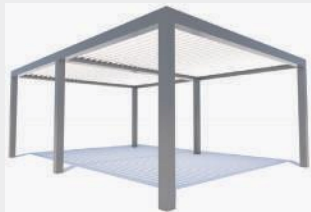

2 Modules



3 Modules



4 Modules in cross



Mitre cut



Between walls



With opening



With cantilever

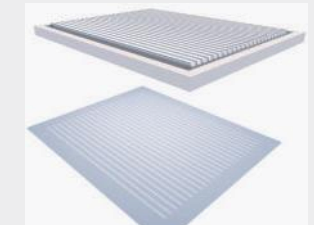

In gap