

Emma

Garden awning

EMMA is more than a structure, it is a way of living outdoors with elegance, freedom and design, where every space it creates is designed so that everything flows in comfort and harmony.

It is the perfect option for those seeking an exterior with character and distinction.

Advantages



UV ray protection



Visual comfort



Optimal temperature

Optional



LED lighting

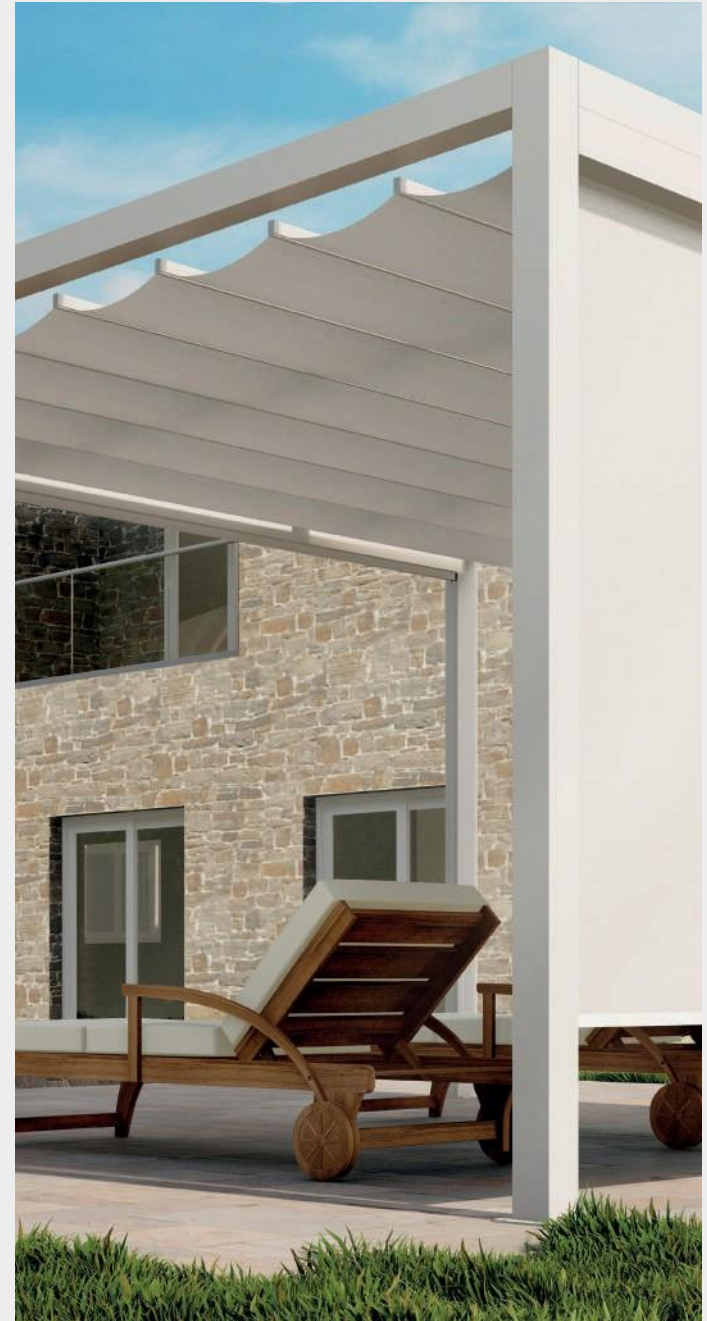

Configurations



Maximum dimensions (m)

- Without intermediate columns

Guides	Max. Line	Max. Output	Maximum clearance height 2.50 m. For greater heights, consult.
2	6,00	7,00	

- With intermediate columns in the line

Guides	Max. Line	Max. Self-supporting	Intermediate columns	
			Output	Wall
3	7,00	7,00	1 + 1	1

Actuation

- Manual (with rope)
- Motorized
- Automated

Suspension

- Self-supporting
- Frontal
- Between walls

Lighting possibilities in warm or neutral light

- Guide profile
- Pilaster profile
- Canvas profile

Accessories



KLAIS 110

Emma



imensions (mm)

Guide 110

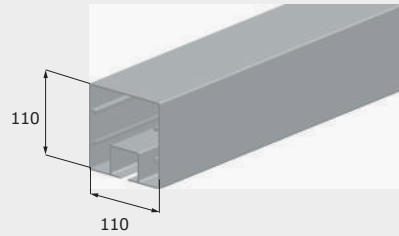

Pillar 110

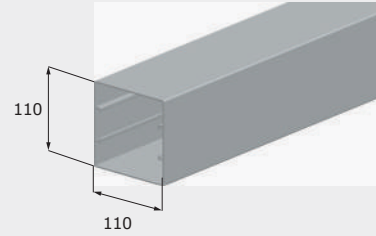

LED guide profile

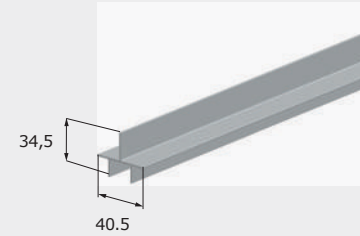

Joint

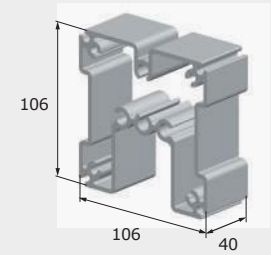

Exterior floor fixing bracket

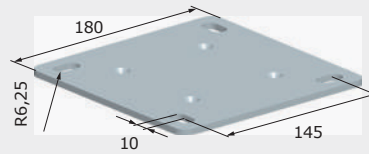

Interior floor fixing bracket

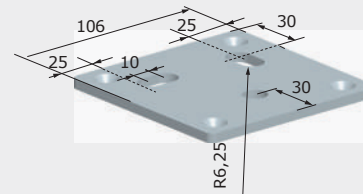

Corner floor fixing bracket

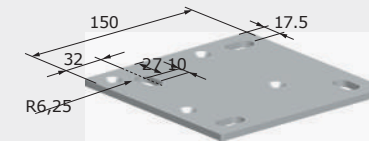

Slot 1 keyway

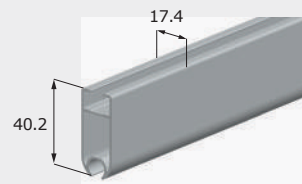

Slot 2 keyways

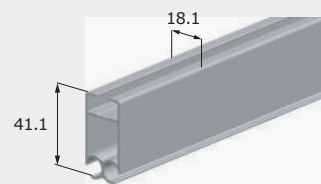

Slot 2 keyways with LED

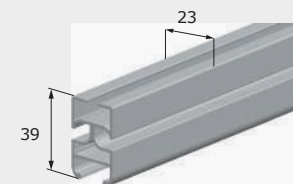

Slot 4 keyways

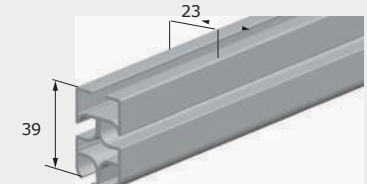

Emma

Structure connection systems

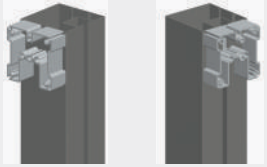

Direct join through internal profile

The structure joining is done by an internal profile fixed with a screw or plate. This creates a compact finish with a minimalist look.

Joining using super slim supports

Besides enabling mounting with inclination, these high-durability steel supports stay in harmony with the dimensions of the structural profiles so as not to affect the overall aesthetic.

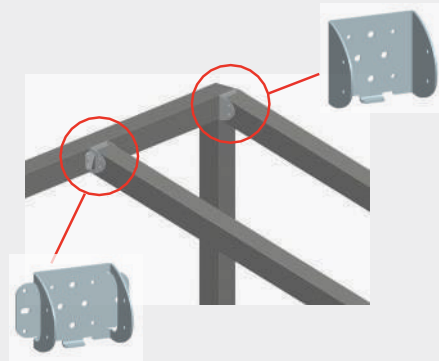

Fast-install decorative cap

The top flat cap is designed not to interfere with the column fixing screws.

Optional reinforcing brackets

The reinforcing brackets for self-supporting or large-scale assemblies ensure stability and beautify the structure.





Between-wall mounting

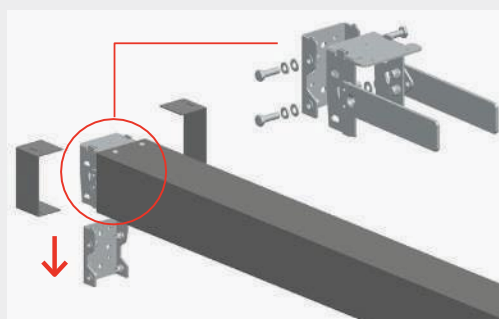

The return bracket optimizes installation between walls by allowing secure and comfortable fixation of the guide. Its completely hidden anchoring system guarantees a clean aesthetic and a flawless professional finish.

Fixing base

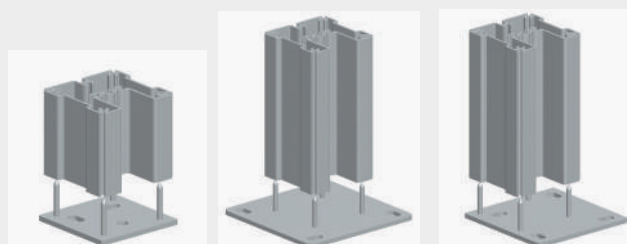

Internal base

External base

Angle base

Floor fixation from the interior fully aligned with the pillar, from the exterior and for the corners of the pergola, externally fixed to the ground.

Canvas profiles

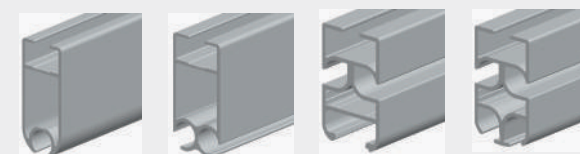

1 slot

2 slots

2 LED slots

4 slots

Beams with a top register to route cables and connections. The cover hugs the profile, preventing water ingress. Quick-connectors on the electronic components.

Emma

Modularity



Door wall



Perpendicular slats



2 Modules

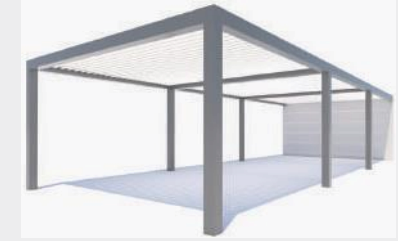

3 Modules



4 Modules



4 Modules in cross



Free-standing

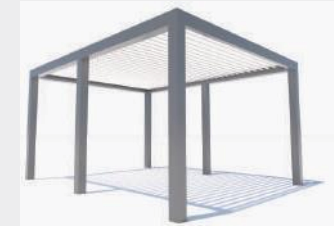

Perpendicular slats



2 Modules



3 Modules



4 Modules in cross

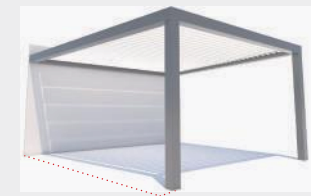

Mitred

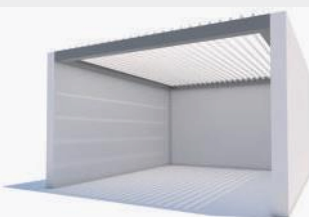

Between walls

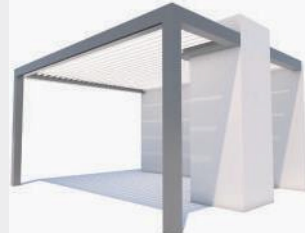

With hollow



With cantilever

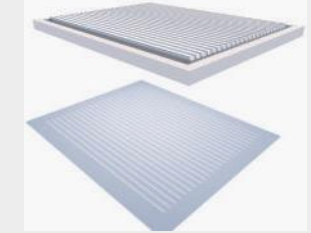

In hollow

